

MythconX

The Wood Between the Worlds

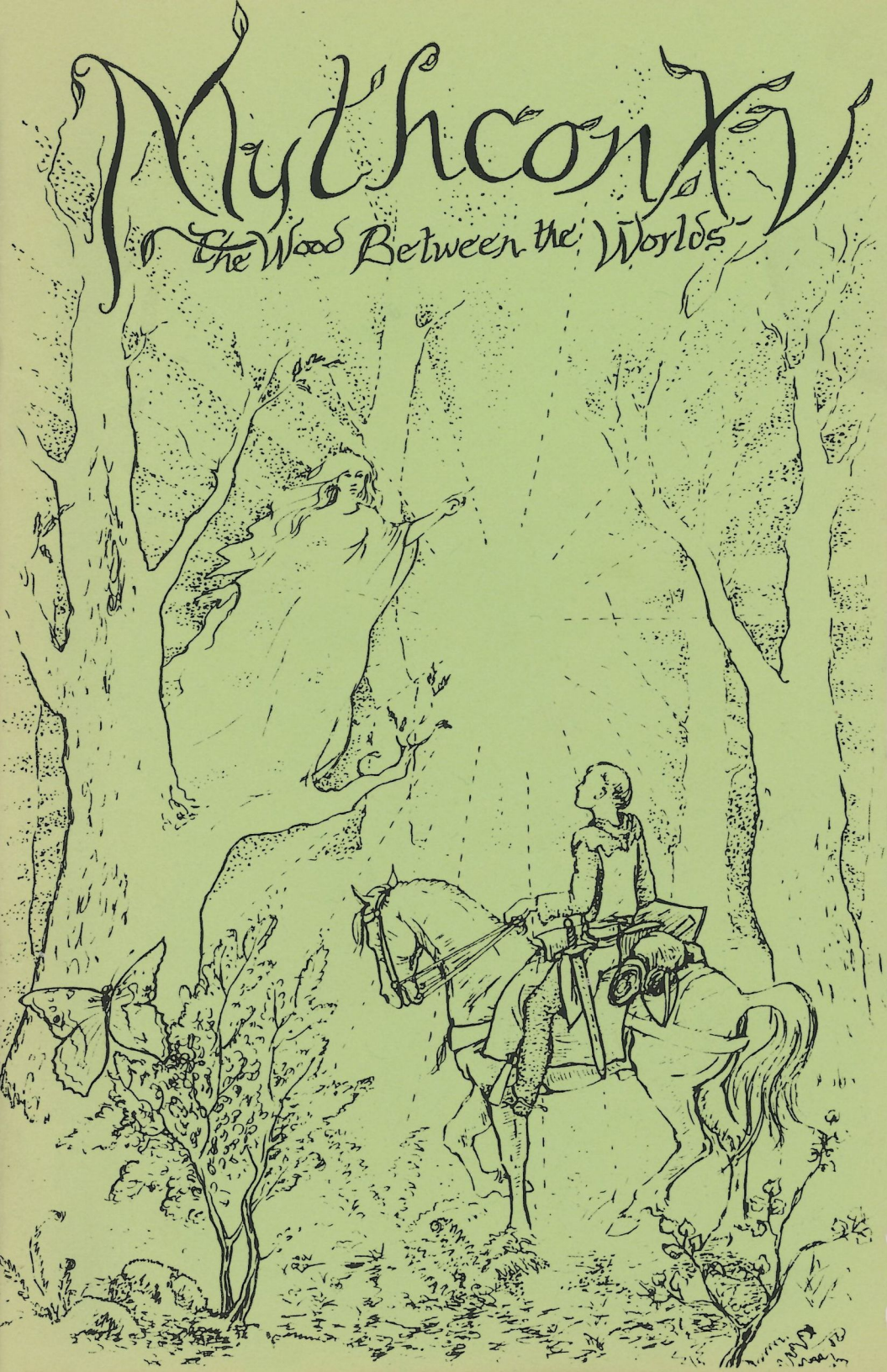

The Oak Tree

*In the Forest of Forever
An ancient oak tree stands,
With golden bough and silver branch--
A legend in the lands.*

*And if you dare to pass the Forest gates,
You must not stray
Or lose your way--
The oak tree waits. . .*

*The Forest of Forever
Is vast as memory,
And dark as all your deepest fears
And trackless as the sea.*

*But for the Wise, who do not fear their fates,
And neither stray
nor lose their way,
the oak tree waits. . .*

*In the Forest of Forever
The crimson dragons lair,
And elves, and unicorns, and all
That's dangerous and fair.*

*But if the seeker loves more than he hates,
And does not stray
Or lose his way,
The oak tree waits. . .*

Diana L. Paxson

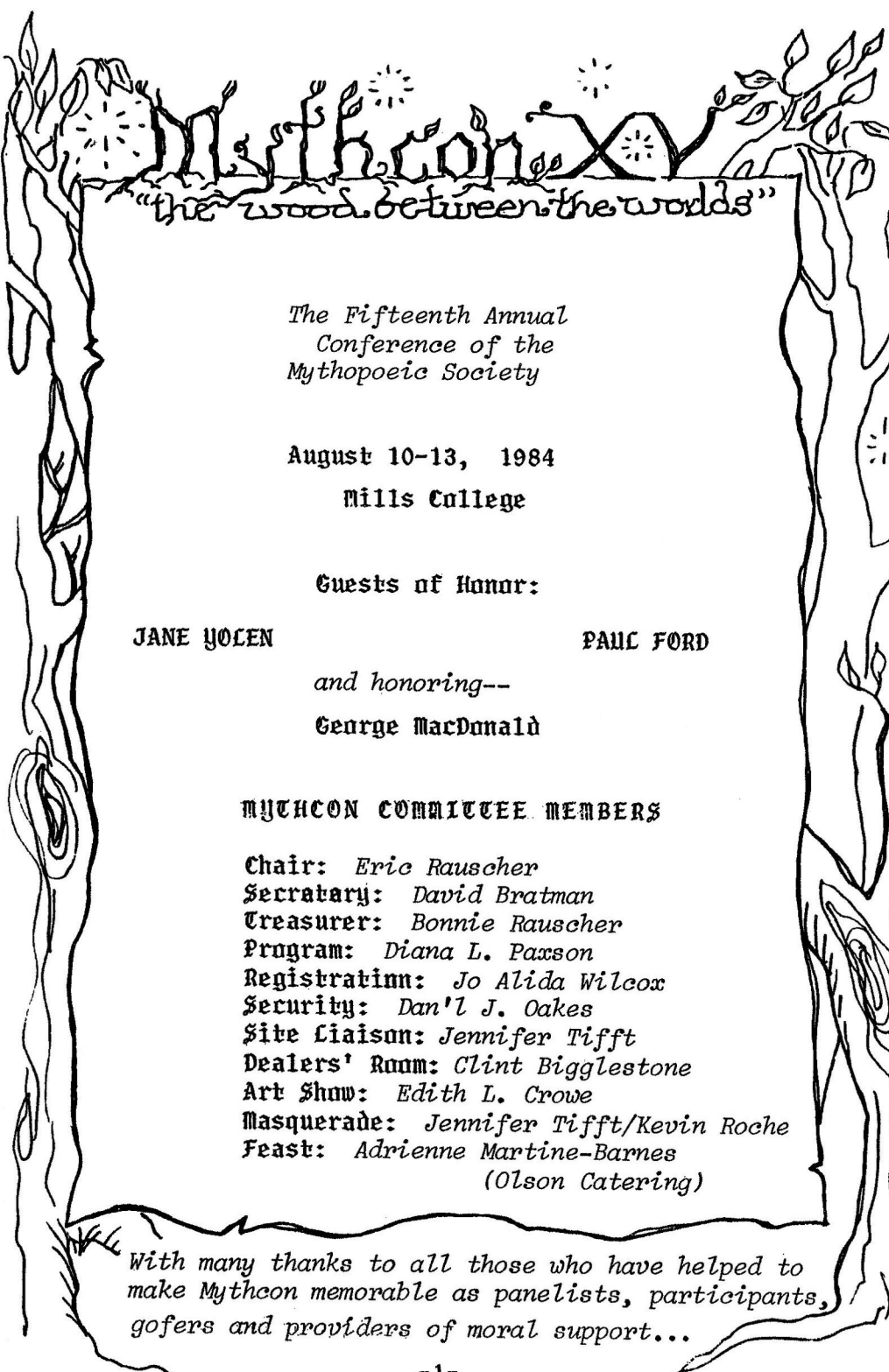

Mythcon

"the wood between the worlds"

*The Fifteenth Annual
Conference of the
Mythopoeic Society*

August 10-13, 1984
Mills College

Guests of Honor:

JANE YOLEN

PAUL FORD

and honoring--

George MacDonald

MYTHCON COMMITTEE MEMBERS

Chair: *Eric Rauscher*
Secretary: *David Bratman*
Treasurer: *Bonnie Rauscher*
Program: *Diana L. Paxson*
Registration: *Jo Alida Wilcox*
Security: *Dan'l J. Oakes*
Site Liaison: *Jennifer Tifft*
Dealers' Room: *Clint Bigglestone*
Art Show: *Edith L. Crowe*
Masquerade: *Jennifer Tifft/Kevin Roche*
Feast: *Adrienne Martine-Barnes*
(Olson Catering)

*With many thanks to all those who have helped to
make Mythcon memorable as panelists, participants,
goers and providers of moral support...*

Mythcon at Mills

- 1 REVELHALL - Rothwell College Center (Student Union)
- 2 CERIN AMROTH - Dormitories & Founders' Commons
- 3 THE LANTERN WASTE - Green next to Revelhall
WIZARD'S CAVE - Rm. L-100
- 4 GARDEN OF BRIGHT IMAGES - Rm. C-14 Lucie
GOBLIN MARKET - Rm. C-27 Sterne
CHAMBER OF MAZARBUL - Rm. 6 Hall

to MacArthur Blvd. & Rt. 580

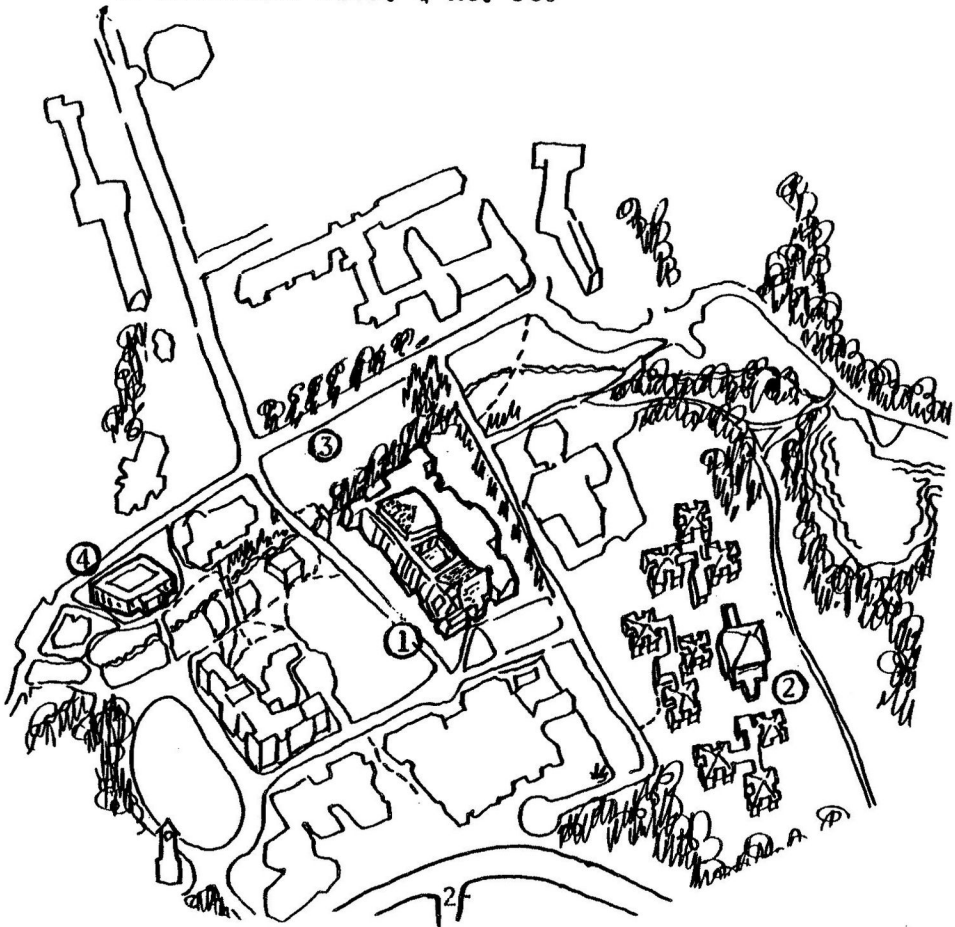

LUCIE STERNE HALL

Goblin Market

Garden of
Bright Images

Wizard's Cave

Chamber of
Mazarbul

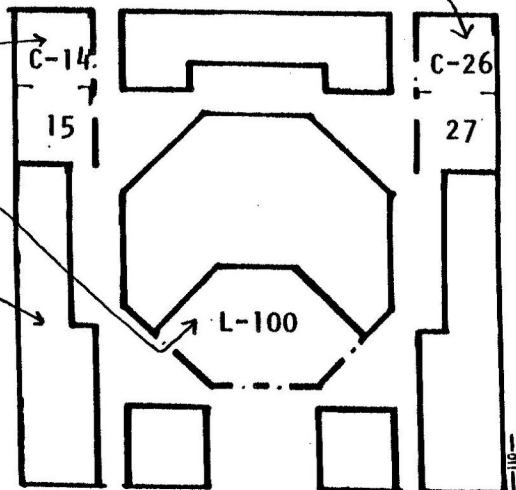

REGISTRATION:

The Registration Table on the porch of the Revelhall will be open:

Friday, August 10th-- 2:00 to 10:00 p.m.

Saturday, August 11th-- 9:00a.m. to 12:00 noon

Sunday, August 12th-- 9:00 a.m. to 12:00 noon

If you arrive at an odd hour and need to register, ask for JO WILCOX.

Schedule:

FRIDAY, AUGUST 10th:

2:00 p.m. -- Registration opens, Revelhall

6:00 p.m. to whenever -- Welcome Party and
Bardic Revel, Revelhall

SATURDAY, AUGUST 11th:

3:30 a.m. -- Meeting to discuss sale of the College
lands. . .

7:00 a.m. -- Breakfast, Dining Commons, Cerin Amroth

8:00 - 10:00 a.m. -- Art Show and Dealers' set up

8:30 a.m. -- form up for Procession in front of
Dining Commons

8:45 a.m. -- Procession to Revelhall

9:00 a.m. -- Opening Ceremonies (Revelhall)
Guest of Honor Speech, Jane Yolen

10:00 a.m. -- Art Show and Goblin Market open (Lucie Sterne)

10:00 a.m. -- Panel, *A Tribute to George MacDonald*
Roy Carlisle, John Wellwood, Bonnie
Rauscher, John Young (Revelhall)

10:00 a.m. -- Paper, *The Rewards of Reading Fantasy*
Karl Schorr (Wizard's Cave)

10:00 a.m. -- Jon DeCles reads from *The Piswyck Papers*
(Chamber of Mazarbul)

11:00 a.m. -- Paper, *The Childhood of C.S. Lewis*
Ruth James Cording (Revelhall)

11:00 a.m. -- Paper, *The Boiling Cauldron: Medieval
Witchcraft and the Madness of Society*
Tina Fields (Wizard's Cave)

11:00 a.m. -- Reading, Evangeline Walton (Chamber of
Mazarbul)

- 11:30 a.m. -- Reading, Diana L. Paxson (Chamber of Mazarbul)
- 12:00 noon -- Lunch, Dining Commons (Cerin Amroth)
- 1:00 p.m. -- Paper, *Deforestation: Meaning and Myth in "The Battle of the Trees"*
Leigh Ann Hussey (Revelhall)
- 1:00 p.m. -- Paper, *C.S. Lewis as Ecumenical Spiritual Director: a Look at his Theology of Prayer and Discerning God's Will*
Paul F. Ford (Wizard's Cave)
- 1:00 p.m. -- Reading, Adrienne Martine-Barnes (Chamber of Mazarbul)
- 2:00 p.m. -- Panel, *Celtic Twilight or Celtic Dawn?*
Roberta MacAvoy, Adrienne Martine-Barnes, Diana L. Paxson, Paul Edwin Zimmer
Duncan Lunan (Revelhall)
- 2:00 p.m. -- Paper, *In Search of the God Incarnate: Richard Adams and C.S. Lewis*
Francisco Collado Rodriguez (Wizard's Cave)
- 2:00 p.m. -- Reading, Richard A. Lupoff (Chamber of Mazarbul)
- 3:00 p.m. -- Paper, *The Transcosmic Journeys in the Chronicles of Narnia*, Steve Yandell (Revelhall)
- 3:00 p.m. -- Panel, *Forests of Fantasy*, Jane Yolen, Richard A. Lupoff, Evangeline Walton, Jon DeCles (Wizard's Cave)
- 3:00 p.m. -- Paper, *The Role of Women in THE LORD OF THE RINGS*, John Lauck (Chamber of Mazarbul)
- 4:00 p.m. -- Paper, *Changing, Fearfully Changing: Sayers' STRONG POISON*, Nancy-Lou Patterson (Revelhall)
- 4:00 p.m. -- Paper, *The Epic Hero and Society*, Ellie Farrell (Wizard's Cave)

- 5:30 p.m. -- Dinner, Dining Commons (Cerin Amroth)
- 6:30 p.m. -- Panel, *Collecting Fantasy Books*, Charles N. Brown, Richard A. Lupoff, Eric Rauscher, Tom Whitmore, John Young, (Revelhall)
- 6:30 p.m. -- Roberta MacAvoy Reads T.S. Eliot (Chamber of Mazarbul)
- 7:00 p.m. -- Reading, Paul Edwin Zimmer (Chamber of Mazarbul)
- 7:30 p.m. -- Masquerade judges and contestants assemble in the Revelhall
- 8:00 p.m. -- *A Masquerade of Myths*, followed by sundry entertainments. . .
- 10:00 p.m. -- (or after the Masquerade)
Bardic Circle (Revelhall)
- Moon Ritual (place to be announced)

SUNDAY, AUGUST 12th:

- 9:00 a.m. -- Christian Worship, conducted by Rev. Elizabeth Harrod (Revelhall)
- 9:00 a.m. -- Paper, *Arwen: Shadow Bride*, Melanie Rawls (Wizard's Cave)
- 10:00 a.m. -- Reading, Jane Yolen (Wizard's Cave)
- 11:00 a.m. -- Panel, *Children's Fantasy*, Glen Goodknight, Patricia McKillip, Pat Witham, Jane Yolen (Revelhall)
- 11:00 a.m. -- Paper, *The Wonder of Passage, the Making of Gold (OUT OF THE SILENT PLANET)* John Hollwitz (Chamber of Mazarbul)
- 11:00 a.m. -- Reading, Marion Zimmer Bradley (Wizard's Cave)
- 12:00 noon -- Lunch, Dining Commons (Cerin Amroth)
- 1:00 p.m. -- Paper, *Self-Esteem or Self-Forgetfulness?* MacDonald and Lewis, Paul F. Ford (Wizard's Cave)

- 1:00 p.m. -- Slide Show, *Symbols and Images of Mythic Power, Part 1*, Tim Callahan (Revelhall)
- 2:00 p.m. -- Workshop, *Symbols and Images of Mythic Power, Part 2*, Tim Callahan (Revelhall)
- 2:00 p.m. -- Reading, Patricia McKillip (Chamber of Mazarbul)
- 2:00 p.m. -- *An Inklings Poetry Reading* (Wizard's Cave)
- 3:00 p.m. -- Panel, *Music and Magic*, Jon DeCles, Roberta MacAvoy, Patricia McKillip, Diana L. Paxson (Revelhall)
- 3:00 p.m. -- Mythcon Auction (Wizard's Cave)
- 3:00 p.m. -- Mythcon Olympics (Lantern Waste)
- 4:00 p.m. -- Authors' Autograph Session (Revelhall)
- 5:00 p.m. -- The Feast in the Woods (Lantern Waste)
- 7:00 p.m. -- Panel, *The Ecology of Faerie*, Marion Zimmer Bradley, Paul F. Ford, Adrienne Martine-Barnes, Evangeline Walton (Wizard's Cave)
- 8:30 p.m. -- Play, *The Wood Witch*, by Diana L. Paxson (Revelhall), followed by entertainment and Bardic Circle

MONDAY, AUGUST 13th:

- 9:00 a.m. -- Reading, George MacDonald (Revelhall)
- 9:00 a.m. -- Paper, *Imagery of Spirityal Growth in the CHRONICLES OF NARNIA*. Doris Myers (Wizard's Cave)
- 10:00 a.m. -- Paper, *Uncouth Innocence (on Chretien de Troyes, Wolfram von Eischenbach, and J.R.R. Tolkien)* J.S. Ryan (Revelhall)
- 10:00 a.m. -- Mythopoeic Society Members Meeting (Wizard's Cave)
- 11:00 a.m. -- Closing Ceremonies and Guest of Honor Speech by Paul F. Ford (Revelhall)

Jane Yolen

Our Writer Guest of Honor is both prolific and multi-talented. Some of her more notable books for children include the National Book Award nominee, *THE GIRL WHO CRIED FLOWERS* (which also won the Golden Kite Award), and the Society of Children's Book Writers Honor Books, *THE TRANSFIGURED HART* and *MOON RIBBON*. Yolen's sf juvenile, *DRAGON'S BLOOD* (Dell, 1982), and *THE GIFT OF SARAH BARKER*, were American Library Best Books for Young Adults. Yolen is also a regular contributor to the major sf and fantasy magazines and anthologies. A poetry and story collection, *NEPTUNE RISING*, was published by Putnam in 1982, and *TALES OF WONDER* appeared from Schocken in 1983. Yolen's adult fantasy novel, *CARDS OF GRIEF*, will be published by Ace Books this fall.

In addition to fiction, Yolen has published two textbooks: *WRITING BOOKS FOR CHILDREN* (Writer, Inc., 1973, 1982), and *TOUCH MAGIC: Fantasie, Faerie, and Folklore in the Literature of Childhood* (Philomel, 1981). She is the author of two songbooks, several non-fiction books for children, and many poems ("*Neptune Rising*" was a Rhysling Award nominee in 1983).

Yolen's work displays her deep interest in-- and knowledge of-- myth and folklore, and her respect for oral tradition and the craft of storytelling. She blends time-tested elements from the "cauldron of story" with psychological insight, to produce fantasy that is as harmonious to the ear as it is pleasing to the eye.

Besides writing, Yolen has been a lecturer at Smith College, and has served as Chair of the Board of Library Trustees and on the Arts Council of Hatfield, Massachusetts, her home. She holds a B.A. from Smith, a M.Ed. from the University of Massachusetts, and the Doctor of Laws degree from the College of Our Lady of the Elms.

--Diana L. Paxson

Paul F. Ford

As our Scholar Guest of Honor, we have the author of *COMPANION TO NARNIA* (Harper & Row, 1980, 1983), which received the 1982 Mythopoeic Award for Scholarship. He has also produced an audiocassette program, *A DAY IN NARNIA*, for Franciscan Communications, and is the consultant for the series of films of the Chronicles of Narnia being developed by Glenray Productions of Pasadena (beginning with *THE MAGICIAN'S NEPHEW* in Thanksgiving of 1986). He is also on the Board of Directors of The Kilns, Ltd., which is purchasing and preserving Lewis' home in Oxford, and is a founding director of the Southern California C.S. Lewis Society and was the first editor of its quarterly journal, *THE LAMP POST*.

Ford received a B.A. in Philosophy and an M.A. in Religion with the thesis, *THE LIFE OF THE WORLD TO COME IN THE WRITINGS OF C.S. LEWIS*. He now teaches theology at Loyola Marymount University in Los Angeles and at Fuller Theological Seminary in Pasadena, where he is working on his doctorate in Systematic Theology. His dissertation will be titled, *C.S. LEWIS, ECUMENICAL SPIRITUAL DIRECTOR*, and there are plans for its publication by Harper & Row after Ford's graduation in June of 1985.

Ford studied for the Roman Catholic priesthood, though he was never ordained, and was a Benedictine monk for five years. He has not yet decided what he will do when he finishes his doctorate, but it will include both teaching and writing.

In the future, Ford would like to research and write on the human experiences of forgiveness, jealousy, acedia (restless depression) and intemperance. Ford is deeply interested in people, and hopes to help them by counseling, teaching, and writing that integrates theology and psychology.

--Glen Goodknight

George MacDonald

George MacDonald's well-deserved reputation as the finest of mid-Victorian fantasy writers, and the high regard in which he was held by C.S. Lewis (who edited an anthology of MacDonald's writings), and J.R.R. Tolkien (whose "*Smith of Wootton Major*" was partly inspired by "*The Golden Key*"), make him an excellent guest for Mythcon.

MacDonald was born in 1824 on a farm in northeastern Scotland. He received a Master's degree in Science from the University of Aberdeen, and worked as a teacher, a librarian, and a minister. By the time he was thirty, however, he had begun his lifelong career as a writer.

Many of MacDonald's novels are realistic romantic "potboilers" inspired by his Scottish boyhood, but he has always returned to his true love, the fantastic. Of his two major adult fantasies, *PHANTASTES*, published in 1868, was his first novel, and *LILITH*, which appeared in 1895, was one of his last. He also wrote the ever-popular *CURDIE* books and other children's fairy tales, including many short stories, such as "*The Golden Key*" and "*The Lost Princess*".

MacDonald has been a major figure in the English literary world. His friends include such noted writers as Lewis Carroll and Charles Kingsley. He has taught literature at the University of London, gave a successful lecture tour of the United States in 1872, and was once considered for the position of Poet Laureate. Besides fiction and poetry, he has published literary essays and sermons, and has edited a critical edition of *HAMLET* as well as a series of children's magazines.

George MacDonald died in Surrey, England, in 1905.

-- David Bratman

Program Notes

PAPERS

David Bratman

Traditionally, the major activity at Mythcon has been the presentation of papers discussing aspects of the works of J.R.R. Tolkien, C.S. Lewis, Charles Williams, and other fantasy authors and members of the Oxford-based literary group known as the Inklings. It is also traditional to have papers which relate to the conference theme. Usually, Mythcon papers are read by their own authors-- in cases where the author is unable to attend, the paper may be read by someone designated by the committee. Papers presented at Mythcon are automatically considered for publication in the Mythopoeic Society's journal, *MYTHLORE*.

PANELS

Diana C. Paxson

In addition to papers by readers of fantasy, we will have several panel discussions featuring writers of fantasy and experts in various relevant fields. This year, our panels will be: *A Tribute to George MacDonald*, a discussion of the life and work of our posthumous Guest of Honor; *Celtic Twilight or Celtic Dawn?* Writers who have drawn upon Celtic culture in their work attempt to account for its peculiar appeal; *Forests of Fantasy*-- In our theme panel, writers discuss legendary forests from Broceliande to the Hundred Acre Wood and consider their significance; *Collecting Fantasy Books*, in which some knowledgeable book collectors discuss what is and isn't valuable, and locating rare finds; *Children's Fantasy*, a discussion of juvenile and Young Adult fantasy literature-- how it differs from books for adults, and in what ways it is the same; *Music and Magic*, which explores the wizardry of Sound; and *The Ecology of Faerie*, a consideration of the Natural Order of fantasy worlds. . .

READINGS

In addition to appearing on panels, most of the writers who will be with us this weekend will also be doing readings. Come and listen to the sound of fantasy as read by its authors, get a preview of new work or a new appreciation of old. There will also be a group autographing session in the Revelhall at 4:00 on Sunday afternoon.

THE BARDIC CIRCLES

Paul Edwin Zimmer

Another Mythcon tradition is the Bardic Circle-- a round-robin orgy of poetry and song which can go on 'till the wee hours. This year we'll be having a formal Circle growing out of the party on Friday evening, and most likely additional rounds on Saturday and Sunday as well after the scheduled entertainments. So tune up your instruments and gather together all your favorite poetry and we'll see you there.

ENTERTAINMENT

Diana L. Paxson

It's the custom at Mythcon for members to present music, poetry, and drama for the entertainment of the company. If you would like to perform your music or poetry as part of the program, contact me on Friday or Saturday morning. We'll have room for a few pieces each as part of the Opening Ceremonies, before and after the Masquerade, after the play, and during the Closing Ceremonies.

THE MASQUERADE

Jennifer Tiffet/Kevin Roche

The "Masquerade of Myths" will take place on Saturday evening. Contestants should gather in the Revelhall at 7:30 p.m. to fill out entry forms and receive instructions on procedure.

THE ART SHOW

Edith Crowe

As always, Mythcon is featuring an exhibit of Fantasy Art. Artists are welcome to enter their work, and members are urged to view it! Each artist will set a minimum bid on every piece to be sold and prospective buyers may bid on the attached form. Items with written bids will be auctioned on Sunday between 3:00 and 5:00 p.m. All other works will be sold for the minimum bid. If the work you want has not been auctioned, you can pay for it and pick it up at the end of the auction period. The Art Show will be located in the Garden of Bright Images (Room 14-15, Lucie Sterne Hall) and will be open from 10-6 on Saturday and from 9-4 on Sunday.

THE GOBLIN MARKET

Clint Bigglestone

This year Mythcon includes a marketplace for fantasy-oriented books, jewelry and other wares. "Come buy. come buy. . ." The Goblin Market is also located in Lucie Sterne Hall (Room 26-27), and will be open the same hours as the Art Show.

RELIGIOUS SERVICES

Diana L. Paxson

Since Saturday night will have a full moon, instead of a Sunday morning service there will be an evening Moon Ritual drawing on the traditions of paganism. This will take place after the Masquerade, and the location-- outdoors or inside depending on the weather-- will be announced then. This ritual is open to all those of good will.

On Sunday morning, the Rev. Elizabeth Harrod will celebrate the Holy Eucharist in the Revelhall. This service is also open to all those who would like to join in it.

In addition, churches of a variety of denominations can be found near the Mills campus.

FILM AND GAMES

Eric Rauscher

Just in case you don't think there's enough things to do, for your special entertainment we are offering a unique feature-- the MYTHCON OLYMPICS (why should Los Angeles have all the fun?) Events in this exciting competition will include:

- * The Mushroom Nose Push
- * The Tree Pun Contest
- * Pin the Motif on the Tale Contest
- * Creative Pronunciation of Welsh Competition
- * The Book Pass
- * Title Charades

Join us on the lawn (the Lantern Waste) at 3:00 p.m. on Sunday and work up a good appetite for--

THE FEAST IN THE WOODS

Adrienne Martine-Barnes

This year's Feast will be prepared by the same caterers who did such a fine job for us three years ago. In keeping with the woodland theme, except for the High Table (for Guests of Honor and those who would find picnic style difficult) we will feast upon the grass (ah, er-- sitting on the grass). Blankets will be provided, and those who do not have Feast tickets and would like to bring their own food are welcome to spread their own blankets and join us.

*Menu: sliced roast beef, cold ham, cold chicken legs,
red potato salad, cheese wheels of brie and
cheddar, whole cut fruit display
chocolate brownies
red and white wine, cranberry juice, cider*

The Mythopoeic Fantasy Award will be presented at the Feast.

THE PLAY

This year Mythcon will premiere a new play, *THE WOOD WITCH*, by Diana L. Paxson.

Cast and crew for this production include the following:

<i>MARA, a woman fleeing her devastated home</i>	Leigh Ann Hussey
<i>The Dryads:</i>	
<i>WILLOW.</i>	Bonnie Goodknight
<i>IVY.</i>	Jennifer Tifft
<i>OAK.</i>	Diana L. Paxson
<i>SYLVANUS, a faun</i>	Kevin Roche
<i>THE HORNED GOD</i>	Jon DeCles
<i>THE FORESTER</i>	Paul Edwin Zimmer
<i>THE WOODWITCH.</i>	Tracy Blackstone
<i>wild animal voices</i>	Fiona Zimmer Ian Studebaker
<i>apparition of Mara's husband.</i>	David Bratman
<i>Mara's doppelganger.</i>	Heather Jones
 <i>Sets and Costumes</i>	 Kelson, Diana Paxson
 <i>Music.</i>	 Heather Jones, Diana Paxson
 <i>Lights</i>	 Lynx Crowe



ABOUT MILLS COLLEGE

Those who are staying in College will find a packet of information in their rooms. College facilities such as the swimming pool next to the Revelhall are free to resident members and available at a small charge to other conference members. You are also encouraged to explore the campus.

Room registration is from 3:00 to 10:00 p.m. Check-out time is 9:00 a.m. The College emergency number is 430-2064. If you have a problem involving the College, talk to our liaison, Jennifer Tifft, or to Eric Rauscher.

NEARBY MOTELS

Motel 6 -- 4919 Coliseum Way, off Highway 17 just south of the High Street exit (534-8185)

Coliseum Motel -- 4801 Coliseum Way, next door to the Motel 6 (532-4084)

Holiday Inn -- off Highway 17 at the Hegenberger Rd. exit (562-5311)

Airport Travelodge -- 150 Hegenberger Rd., a half mile west of the Highway 17/Hegenberger Rd. interchange (635-5300)

GETTING AROUND

Buses: (AC transit fare 60¢)

To the Airport-- #57 southbound on MacArthur Blvd.

To downtown Oakland -- #57 northbound on MacArthur Blvd.
On weekdays the "N" and #34 Express busses run north on MacArthur. The "N" continues on into San Francisco.

Other buses -- the #79 runs along High St. from Alameda to Mountain Blvd. in the hills.

BART trains marked "Richmond" go north via downtown Oakland and Berkeley. "Fremont" trains go south. You can transfer to San Francisco from the Richmond line.

QUICK MUNCHIES

As long as they last, soft drinks will be available from the Mythopoeic Society table in the Dealer's Room at a modest price.

There is a small shopping district on the south side of campus at the corner of MacArthur Blvd and Seminary Ave with a variety of food shops, a mini-mart, and other services.

The Eastmont Mall is located one mile south of campus off MacArthur Blvd. This is a large indoor shopping mall, with department, grocery, drug, and many other kinds of stores, and many small fast-food and cafeteria style eating places.

The nearest 24-hour restaurant is Denny's, at 601 Hegenberger Rd., near the Highway 17 interchange.

RECOMMENDED RESTAURANTS

Downtown Oakland:

The Kapok-- 1511 Webster St., Alameda.

The secret hiding place of the best Chinese food in the Oakland area.

Mama Mia's -- 3355 Lakeshore Ave. (east of Interstate 580 at Lake Merritt), fairly inexpensive, pizza parlor/Italian restaurant (465-8320)

Mexicali Rose -- 701 Clay St. (2 bl. north of Broadway, just east of Hwy 17), a good inexpensive Mexican restaurant that stays open until 3:30 a.m. seven nights a week (451-2450).

There are innumerable good Chinese restaurants in Oakland, particularly in Chinatown. For more eating ideas, check the local Yellow Pages or ask any of the conference members from Oakland or Berkeley.

BOOKSTORES

The Oakland/Berkeley area is rich in bookstores. Particularly good hunting grounds are the University of California shopping district on Bancroft Way and Telegraph Ave. in Berkeley, the Rockridge district in north Oakland, and parts of downtown Oakland.

Holmes' Bookstore -- 274 Fourteenth St. in downtown Oakland, is the largest and best Used Book store in the city.

The Other Change of Hobbit -- 2433 Channing Way (inside the brick building), and

Dark Carnival (2812 Telegraph Ave.), both in Berkeley, specialize in fantasy and science fiction.

Logos -- 2398 Telegraph Ave., has the best collection of mythic and Christian material, including an entire rack devoted to the Inklings.

* * * * *

CROSSWORD PUZZLE: The Forests and the Trees

All the names in this puzzle relate to trees, forests or authors and works which feature them. Directions are on the next page; answers are at the end of the Program Book.

ACROSS:

- ① *Through this Wood the Jabberwock once came.*
- 2 *Hobbits found refuge in his Hall*
- 3 *In this land lies the Lantern Waste*
- 4 *In _____ Forest, Robin Hood dwells*
- 5 *who would rather not climb to get hunny*
- 6 *maker of sweet sound*
- 7 *Treebeard, and his forest*
- 8 *The Forest of _____ lies in Prydain*
- 9 *Priest of the golden sickle and the oak tree*
- 10 *The beginning of the journey to Sorrow's End*
- 11 *Don't cry "Attercop" in _____ Wood*
- 12 *The great forest through which Istvan DiVega passed on his way from Tarentia to Manjipe*

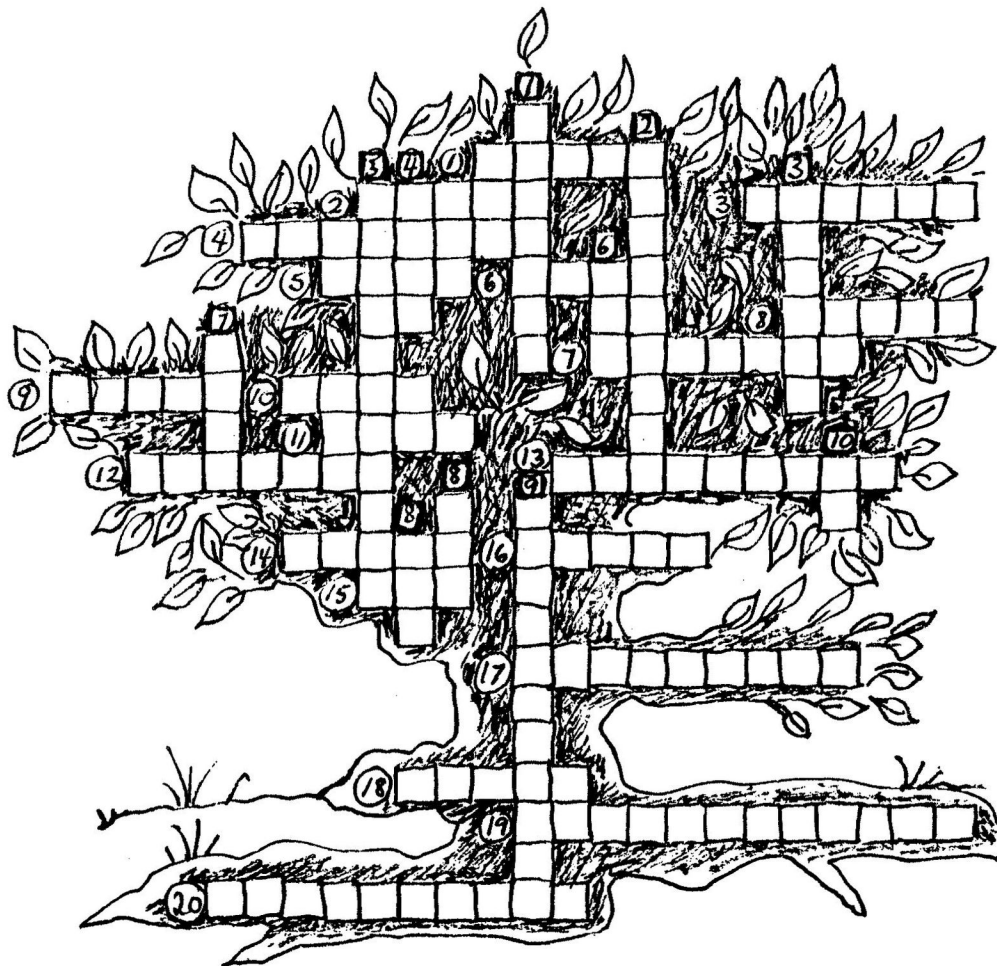

- 13 The silver Tree of Valinor
- 14 In this forest love's labours were not lost
- 15 see #8, Down
- 16 The Hunter of Middle Earth (one of the Valar)
- 17 _____ wrote of the Enchanted Wood in the Land of Dreams
- 18 DeCamp placed this forest on the continent of Atlantis
- 19 Through the Jungle of _____ Jophan pursued his quest for the Enchanted Duplicator
- 20 The _____ Forest in Narnia where the seven black dwarf brothers lived

DOWN:

- 1 In the _____ Aker Wood Pooh walks still
2 This tree reaches from Niffleheim to Asgard
3 In the land of Poictesme lies the Forest of _____
4 Resident of the Forest moon of Endor
5 The domain of Merlin and Nimue
6 One of the fair folk
7 Here grows the Tree of Knowledge of Good and Evil
8 The tree shepherd of Middle Earth
9 The Golden Wood where Galadriel sang
10 Country of the Blue Forest through which runs a
Yellow Brick Road



SCIENCE FICTION & FANTASY

2433 CHANNING WAY

BERKELEY, CA. 94704

(415) 848-0413

INTERMOUNTAIN SCIENCE FICTION REGIONAL CONVENTIONS, INC.

presents

WESTERN RE-CON II

OCTOBER 19, 20, and 21 1984

DOWNTOWN HILTON

GUESTS OF HONOR

150 West 500 South
Salt Lake City, Utah

MARION ZIMMER BRADLEY

Creator of
DARKOVER

ANNE McCAFFREY

Creator of
THE DRAGON RIDERS OF PERN

RICHARD & WENDY PINI

Creators of
ELFQUEST

Special Guest Toastmaster - PAUL EDWIN ZIMMER
Creator of 'Dark Border'

MEMBERSHIPS

\$17.00 from 1 March to 1 October 1984
\$25.00 at the door

For information call or write:

Ph. (801) 263-4666
Western ReCon
P.O. Box 510581
Salt Lake City, Utah
84151-0581

Films
Panels
Gaming Tournaments
Art Show and Sale
Dealer Room
Banquet - cost \$10.00
Masquerade Friday Night
at 8:30
Parties
AND MUCH MORE ! ! !

INTERMOUNTAIN SCIENCE FICTION WESTERN RE-CON II, P.O. Box 510581, Salt Lake City, UT 84151
19-21 October 1984 Advance Registration Form

NAME (Last, first, initial)

DATE

ADDRESS

CITY

STATE

ZIP CODE

Please check box if you would like to work at
the convention ☐

Request information on (check box) Art Show ☐
Masquerade ☐

MEMBERSHIP
BANQUET
ART SHOW

TOTAL

I enclose: Cash or money order ☐
Check ☐

War Gaming ☐

The Mythopoeic Society

The Mythopoeic Society is a non-profit educational organization for the study, discussion, and enjoyment of fantasy and mythic literature, especially the works of J.R.R.Tolkien, C.S.Lewis, and Charles Williams. It sponsors the annual Mythopoeic Conferences and regional discussion groups and publishes three magazines:

MYTHPRINT-- a monthly bulletin containing news, book reviews, and information on discussion group meetings (\$6/yr);

MYTHLORE, a quarterly journal with scholarly articles and artwork (\$12/yr);

MYTHELLANY, an annual containing fiction, games, and humor (\$2.75/issue).

Copies of Society publications will be available at Mythcon in the Dealer's Room.

For subscriptions, information, etc., write:

The Mythopoeic Society
1008 North Monterey St.
Alhambra, CA 91801



REGISTER NOW Oythcon in the midwest

july 26-29, 1985
wheaton college
wheaton, illinois (near chicago)

A Kinship of Dancers
interplay in the lives and works of
c.s. lewis, j.r.r. tolkien,
and charles williams

Oythcon xvi post office box a3120
chicago, illinois 60690

THE BARDIC ART

A monthly program featuring some of the Bay Area's most exciting artist/performers, presenting original material in a unique setting that combines the intimacy of a club with the resources of a theatre.

THURSDAY, AUGUST 16th-- a theatre performance of *THE WOODWITCH*, by Diana L. Paxson, and *THE CIRCUS OF LONELINESS*, a dramatic sonnet sequence, by Jon DeCles.

THURSDAY, SEPTEMBER 20th-- Paul Edwin Zimmer, performing his epic, *LOGAN*; Frederick J. Mayer, with his consciousness-altering *ALICIAN WALTZ*; the mythic poetry of Elizabeth Harrod; and introducing the song and story of Leigh Ann Hussey.

Performances of THE BARDIC ART take place on the third Thursday of each month at 8:00 p.m. at the WEST END THEATRE, located at Grant and Rose streets in Berkeley (drive through the gate onto the grounds of Martin Luther King Jr. High)

ANSWERS TO THE CROSSWORD PUZZLE ON p. 19

- | | | | |
|----|-------------|----|--------------|
| 1 | Hundred | 1 | Tulgy |
| 2 | Yggdrasil | 2 | Beorn |
| 3 | Acaire | 3 | Narnia |
| 4 | Ewok | 4 | Sherwood |
| 5 | Brocellande | 5 | Pooh |
| 6 | Elf | 6 | Reed |
| 7 | Eden | 7 | Fangorn |
| 8 | Ent | 8 | Idris |
| 9 | Lothlorien | 9 | Druid |
| 10 | Oz | 10 | Holt |
| | | 11 | Mirk |
| | | 12 | Kantara |
| | | 13 | Telperion |
| | | 14 | Arden |
| | | 15 | Ent |
| | | 16 | Orome |
| | | 17 | Lovecraft |
| | | 18 | Sharn |
| | | 19 | Inexperience |
| | | 20 | Shuddering |

DOWN

ACROSS

MYTHCON XV MEMBERS:

<i>Paul F. Ford</i>	<i>Holley Wilkinson</i>	<i>Roy Carlisle</i>
<i>Jane Yolen</i>	<i>Amy Wisniewski</i>	<i>John Wellwood</i>
<i>Shannon Riojas</i>	<i>Veida Wissler</i>	<i>John Young</i>
<i>Sarah Beach</i>	<i>Pat Witham</i>	<i>Duncan Lunan</i>
<i>David Bratman</i>	<i>Lisa Yount</i>	<i>Tom Whitmore</i>
<i>Edith Crowe</i>	<i>Lisa Deutsch-Harrigan</i>	
<i>Dolores Espinosa</i>	<i>Jane M. Bigelow</i>	<i>Lynx Crowe</i>
<i>Eleanor Farrell</i>	<i>Stephen P. Gaddis</i>	<i>Sharon Folsom</i>
<i>Kyle Ferstead</i>	<i>Elisabeth Waters</i>	<i>Clint Bigglestone</i>
<i>Tina Fields-Murphy</i>	<i>Mia F. McDavid</i>	<i>Dan'l J. Oakes</i>
<i>James Gillmon</i>	<i>Glenn T. McDavid</i>	
<i>Rita Gillmon</i>	<i>Paul Edwin Zimmer</i>	
<i>Bonnie Goodknight</i>	<i>Tracy Blackstone</i>	
<i>Arwen Goodknight</i>	<i>Fiona Zimmer</i>	
<i>Tim Callahan</i>	<i>Leigh Ann Hussey</i>	
<i>Glen Goodknight</i>	<i>Diana L. Paxson</i>	
<i>Albert Gwin</i>	<i>Ian Studebaker</i>	
<i>Elizabeth Harrod</i>	<i>Jon DeCles</i>	
<i>Harry Henderson</i>	<i>Kelson</i>	
<i>George Hersh</i>	<i>Christopher Pettus</i>	
<i>Sherman Lewis</i>	<i>Juna Häggart</i>	
<i>Alison Lewis</i>	<i>Susan A. Simons</i>	
<i>Lynn Maudlin</i>	<i>Peter Thiesen</i>	
<i>Donna Miller</i>	<i>John D. Wellwood</i>	
<i>Doris Myers</i>	<i>Nancy Lou Patterson</i>	
<i>Anne Osborn</i>	<i>William A. Curry</i>	
<i>David Oster</i>	<i>Karl Schorr</i>	
<i>Eric Rauscher</i>	<i>Christopher Gilson</i>	
<i>Bonnie Rauscher</i>	<i>Heather Jones</i>	
<i>Susan Rich</i>	<i>Darrell A. Martin</i>	
<i>Kevin Roche</i>	<i>Diana Pavlac</i>	
<i>Katya Rochelle</i>	<i>Lauren Mills Egan</i>	
<i>William Rolls</i>	<i>Barbara Glass</i>	
<i>Dana Kramer-Rolls</i>	<i>Rodema Moseley</i>	
<i>Lester Simons</i>	<i>Evangeline Walton</i>	
<i>Lee Speth</i>	<i>Geoffrey Williams</i>	
<i>William Stoddard</i>	<i>Marion Zimmer Bradley</i>	
<i>Jennifer Tifft</i>	<i>Patricia McKillip</i>	
<i>Pat Tressel</i>	<i>Adrienne Martine-Barnes</i>	
<i>Wendell Wagner</i>	<i>Robertta MacAvoy</i>	
<i>Donna White</i>	<i>Charles N. Brown</i>	
<i>Jo Wilcox</i>	<i>Richard A. Lupoff</i>	

